

Real Cities in the Real World

Gotelind Alber

Sustainable Energy and Climate Policy, Berlin

goalber@online.de

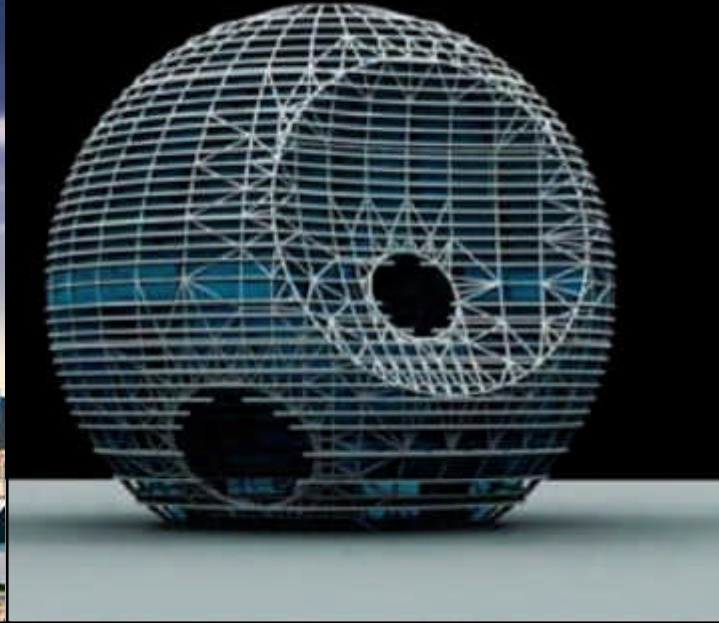

New cities ?



City of the Future

City of the future:

- **human-friendly** (socially just and participatory),
 - **climate-friendly** (low-carbon) and
 - **resilient** (less vulnerable to climate variations and disasters)
- Based on existing structures
 - Built structures and social structures important
 - Wise **application, modification and combination** of available technologies with some new ITC elements, e.g. renovation to passive house standard, full exploration of small-scale renewables, smart flexible public transport

Unresolved Questions and Key Issues

- Compactness to optimise land use/transport versus energy efficiency and renewables
 - Strategic long-term development of infrastructure
- Consider both Megacities and smaller cities and towns
- Innovation needed for
- Transition process towards city of the future,
 - Cities as a political sphere

Focus on Megacities?

- Break-even-point urban - rural population reached, both still increasing
- Majority of urban population lives in smaller cities
- E.g. Germany: 70% of pop. in cities below 100.000
- EU-27:
total number
of local governments:
90.000

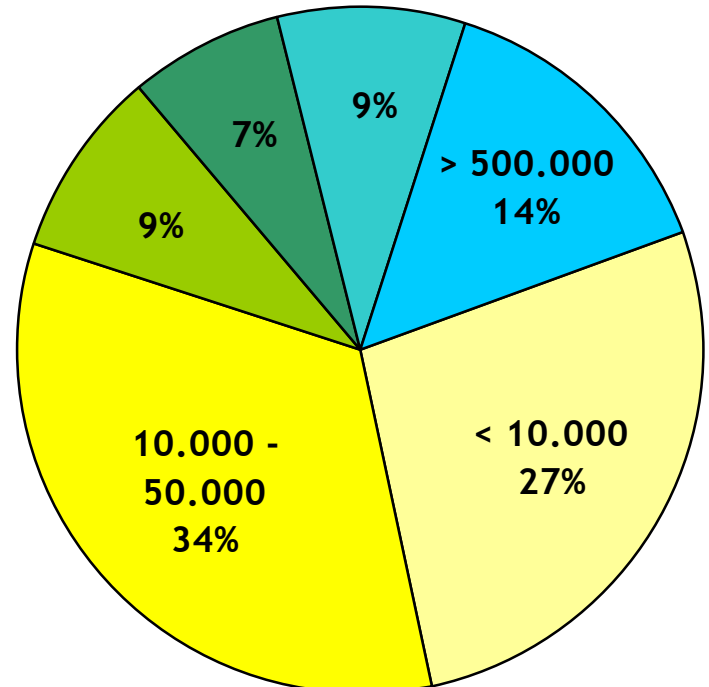

Status of Local Climate Policy

- A few outstanding examples
- A number of quite good examples with some weak points
- A great number of singular actions
- Thousands of other local governments sound asleep

→ Mainstreaming in day-to-day policies required

External Obstacles

(beyond the responsibility of the city)

- Role of local governments underestimated
- Lack of responsibilities and power
- Most local governments underfinanced
Large variation in the share of local expenditure from total public expenditure e.g.
DE: 16%, FR: 20%, UK: 29%, SE: 45%, ES: 54%
- Public sector expected to shrink (outsourcing etc.)
- Lack of national regulations (e.g. energy efficiency)

Internal Obstacles

- Lack of awareness, information and expertise
- Other priorities than climate policy prevailing, e.g. short-term economic interests
- Political process, e.g. dominance of party politics, irrational decisions, lack of effective participatory approaches, too limited time horizon
- Budgetary structure and rules
- Inertia of institutions
- Lack of enforcement
- Lack of cross-departemental collaboration and cooperation beyond city borders

Local government in the UNFCCC process

Separate observer constituency - LGMA

City networks considered as NGOs

Options:

- **Multi-stakeholder process (see CDB)**
- **Short-term:**
 - **Inclusion of local and regional representatives in national delegations**
 - **Consideration of multilevel issues at thematic workshops**
 - **Inclusion of local (and regional) level activities in reporting requirements**

Involvement of Local (and Regional) Levels



Binding quantified commitments

Inclusion of local governments in commitments analogue to proposals for developing countries, e.g. Incentives, SD-PAMs, Action targets

Quality labels and minimum requirements e.g. Climate Star, European Energy Award

Voluntary commitments

e.g. Climate Alliance target

- obsolete under cap & trade system?

The Carbon Market Won't Solve the Problem

- **Project based mechanisms:**
 - Incentives only for individual projects
 - No stimulus for mainstreaming, long-term decisions, and areas with difficulties of quantification
 - Market driven not adequate for all areas
 - No reliability of revenues
 - Additionality?
- **Emissions trading:**
 - Limited influence on total emissions
 - Problem of inventorisation and monitoring

Multi-level Arrangements and Incentives

- **Covenants such as Dutch and Flemish scheme**
Per cap. funding rate, connected to proper planning and implementation of action programme
- **Funding based on real achievements**
 - **Per capita values, relative improvements etc.**
 - **Indicators other than GHG emissions per cap.?**
- **Legal basis / legal requirement for local climate policy**

A Research Agenda on Local Governments and Climate Change Policy

- **Survey and evaluation of existing methodologies (Climate Alliance: Climate Compass, ICLEI: Milestones etc., review of reports)**
- **Influencing factors for cities' carbon intensity**
- **What is best practice?**
- **Design, consultation and testing of incentive programmes and multi-level arrangements incl. monitoring and reporting
Appropriate indicators / performance indices**
- **Governance issues, cross-country comparisons**

Thank you for your attention!

Gotelind Alber

Sustainable Energy and Climate Policy, Berlin

goalber@online.de

Annex1: Climate Compass Compendium of Measures: Activity charts for the fields of action

AGRICULTURE & FORESTRY					
GREEN PUBLIC PROCUREMENT					
TRANSPORT					
ENERGY					
URBAN DEVELOPMENT					
CLIMATE POLICY					
	Step: 1: getting started	2: moving forward	3: forging ahead	4: taking the lead	
A	Define your overall planning strategy	Review the relevant policies in the fields of land use, transport and environment	Identify opportunities, but also hindrances of your current planning policy	Review and eventually adjust existing institutional frameworks	Integrate and amplify planning competences within your local authority
A	Adopt targets and develop a concept	Develop a general commitment to climate policy	Add a global CO2 reduction target	Adopt detailed reduction targets for all relevant sectors	Set targets to become a "100 % renewable" community
B	Institutionalise your climate policy	Determine a responsible officer / department for your future climate policy	Inform and involve all relevant departments in your climate policy	Regularly report to the political decision-makers about the progress of your climate policy	Establish a climate protection agency (including both involved departments and external parties, stakeholders etc.)

Climate Compass Compendium of Measures

Example: Transport

Ambition levels

TRANSPORT					
Step:	1: getting started	2: moving forward	3: forging ahead	4: taking the lead	
A	Develop an integrated transport strategy	Define a vision, set targets and extract priority areas for action	Adopt rules for implementation and planning principles	Set up a detailed action plan	Develop strategies to overcome barriers, identify new focal areas for activities and innovative measures
B	Get your own staff on the right track	Inform your employees about the impact of their travel to and from work and about the alternatives	Set up a mobility plan for your local administration	Value the mobility behaviour of your staff and promote it towards the public	Offer new models for work and work-time to minimise transport load
C	Mobilise stakeholders for sustainable mobility	Involve relevant companies, institutions and organisations in the development of the transport strategy	Train some local authority staff to help companies customise specific mobility plans	Offer accompanying services and set restrictions to support the individual mobility plans	Establish performance agreements with companies and organisations
D	Increase the share of zero carbon modes	Set targets in terms of the market share of cycling and walking	Work continuously on the extension and improvement of your cycling and pedestrian network	Consider cyclists and pedestrians as main actors when reorganising the distribution of roadways	Become a cycling city!
E	Provide a convenient public transport	Increase insights in the possibilities of existing public transport	Improve public transport facilities and services	Develop and implement action plans on smooth and efficient intermodal interchanges	Achieve a best practice public transport system
F	Restrict traffic flows by managing parking space	Increase compliance with existing parking regulations	Start in the city centre to use parking and access restrictions to tempt users back to sustainable modes of transport	Set up and implement step-by-step an integrated parking programme	Introduce regulations to limit parking space in new developments

Themes
and
Tasks

Climate Scan, based on CC Compendium

- For each field of action, mark the cells which best describe actual activities
- For clarification, refer to the detailed descriptions
- Result: Your activity profile

ENERGY					
Step:	1: getting started	2: moving forward	3: forging ahead	4: taking the lead	
A	Define your energy policy and adopt targets	Define fundamental objectives of your energy policy	Lay the ground for your energy policy, formulate the action programme	Adopt detailed targets for individual sectors or subjects	Adopt the target: 100% renewable!
B	Institutionalise your energy policy	Define responsibilities and allocate staff	Install cross-sectoral cooperation structures within the administration	Involve municipally owned companies in the energy policy	Install a local/regional energy agency
C	Use innovative financing schemes	Inform yourself about national and European funding opportunities	Identify first buildings for Energy Performance Contracting (EPC)	Analyse results of your first contract and potentials for enlargement to additional buildings	Reform financial framework conditions to facilitate internal EPC and apply it to all public buildings
D	Bring your own facilities up to scratch	Check selected own facilities in terms of energy use and saving potentials	Establish energy performance standards for municipal buildings	Install an energy management system for all municipal buildings, including energy audits	Improve energy performance standards for public buildings
E	Become a model for sustainable energy use	Define a package of sustainable energy measures with low initial investment or very short pay-back time	Define a package of sustainable energy measures that require higher initial investments	Purchase green electricity to supply a portion of your energy demand	Resolve upon the continuous progression of the share of green electricity
F	Provide "green" public lighting	Analyse potentials for immediate savings in public lighting	Formulate a public lighting policy plan focussing on energy efficiency	Purchase green electricity for public lighting	Implement the policy plan and move forward to 100% Renewable Energy Sources (RES) target for your public lighting network
G	Support the implementation of renewable energy projects	Generate a share of your municipality's electricity and/or heat demand in own RES plants	Set up a land register for the potentials of RES use	Create an offer of green electricity for your citizens	Implement a long term action programme for RES and Combined Heat and Power generation (CHP) to achieve a 100 % community
H	Inform and involve the citizens	Inform the citizens about your energy policy and give hints for own contributions	Install a local energy advice centre	Organise targeted campaigns on energy efficiency	Mainstream energy in education and professional training
I	Refurbish existing housing stock	Inform house-owners about the potentials to increase the energy efficiency of their building	Collect data and set up a land register for energy use in the housing stock	Label the housing stock according to their energy efficiency and offer targeted advice and recommendations	Set up a loan programme for retrofitting the housing stock in terms of energy efficiency
J	Work on green office buildings	Promote your energy management system towards external companies	Investigate and establish energy performance standards for offices	Set up demonstration projects	Establish energy forums and offer energy performance services

Strategising, based on CC Compendium

- Mark the cells where you intent to be more active
- Again, refer to detailed descriptions and case studies
- Result: Proposed activity profile as input for decision-makers

ENERGY				
Step:	1: getting started	2: moving forward	3: forging ahead	4: taking the lead
A Define your energy policy and adopt targets	Define fundamental objectives of your energy policy	Lay the ground for your energy policy, formulate the action programme	Adopt detailed targets for individual sectors or subjects	Adopt the target: 100% renewable!
B Institutionalise your energy policy	Define responsibilities and allocate staff	Install cross-sectoral cooperation structures within the administration	Involve municipally owned companies in the energy policy	Install a local/regional energy agency
C Use innovative financing schemes	Inform yourself about national and European funding opportunities	Identify first buildings for Energy Performance Contracting (EPC)	Analyse results of your first contract and potentials for enlargement to additional buildings	Reform financial framework conditions to facilitate internal EPC and apply it to all public buildings
D Bring your own facilities up to scratch	Check selected own facilities in terms of energy use and saving potentials	Establish energy performance standards for municipal buildings	Install an energy management system for all municipal buildings, including energy audits	Improve energy performance standards for public buildings
E Become a model for sustainable energy use	Define a package of sustainable energy measures with low initial investment or very short pay-back time	Define a package of sustainable energy measures that require higher initial investments	Purchase green electricity to supply a portion of your energy demand	Resolve upon the continuous progression of the share of green electricity
F Provide "green" public lighting	Analyse potentials for immediate savings in public lighting	Formulate a public lighting policy plan focussing on energy efficiency	Purchase green electricity for public lighting	Implement the policy plan and move forward to 100% Renewable Energy Sources (RES) target for your public lighting network
G Support the implementation of renewable energy projects	Generate a share of your municipality's electricity and/or heat demand in own RES plants	Set up a land register for the potentials of RES use	Create an offer of green electricity for your citizens	Implement a long term action programme for RES and Combined Heat and Power generation (CHP) to achieve a 100 % community
H Inform and involve the citizens	Inform the citizens about your energy policy and give hints for own contributions	Install a local energy advice centre	Organise targeted campaigns on energy efficiency	Mainstream energy in education and professional training
I Refurbish existing housing stock	Inform house-owners about the potentials to increase the energy efficiency of their building	Collect data and set up a land register for energy use in the housing stock	Label the housing stock according to their energy efficiency and offer targeted advice and recommendations	Set up a loan programme for retrofitting the housing stock in terms of energy efficiency
J Work on green office buildings	Promote your energy management system towards external companies	Investigate and establish energy performance standards for offices	Set up demonstration projects	Establish energy forums and offer energy performance services

Annex 2: Relevant City Networks

Climate Alliance of European Cities

- Some 1400 members in Europe
- Covers all aspects of climate change policy
- Climate protection target:
initially: 50% GHG reduction
new: 10% reduction every 5 years
- Various projects in core areas of climate policy
- Partnership with indigenous rainforest peoples
- <http://www.climatealliance.org>

ICLEI - Local Governments for Sustainability

- **Some 180 members in Europe**
- **Plus offices and members in various world regions**
- **Cities for Climate Protection (CCP) Campaign**
- **Milestones method (step by step approach)**
- **Various projects in the energy and transport sector, public procurement**
- **<http://www.iclei.org>**

Energie-Cités

- 140 members in 24 European countries and representing more than 500 towns and cities
- Promotion of local sustainable energy policies.
- Best practice, collaboration projects, lobbying
- <http://www.energie-cites.org/>